

# CERTIFICATE OF LOCATION OF GOVERNMENT CORNER

Northeast Corner of Section 34, Township 107, Range 41, 5th P.M.

STATE OF MINNESOTA, County of Murray

At the corner location shown on the sketch:

On June 17, 1995 found a R.R. spike (SEE BACK)  
DATE

left monument as found,  lowered monument,  removed monument (explain)

On June 17, 1995 placed a 5/8" iron stake w/seal #11943  
DATE

### SKETCH OF REFERENCE TIES

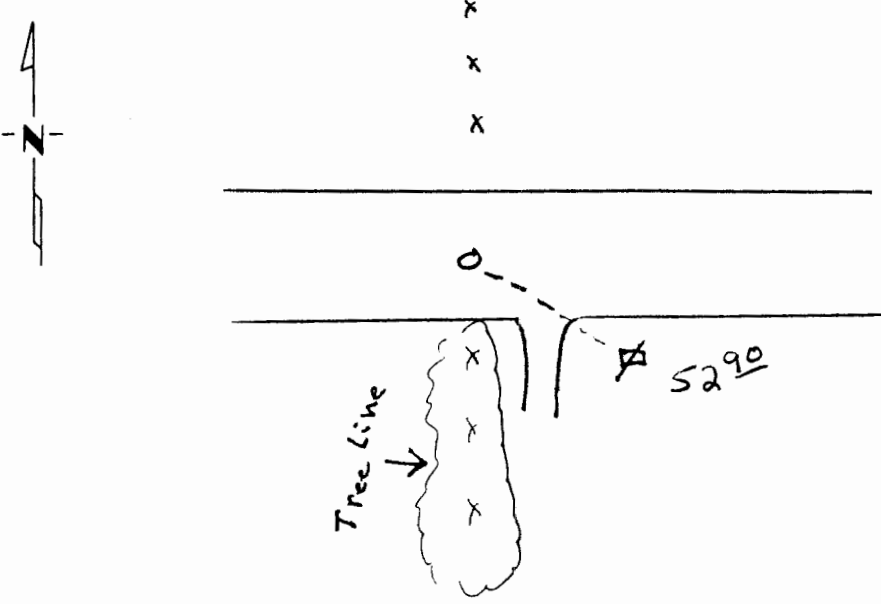

P.K. nail & seal in power pole SE 52.90'

Statement of evidence relative to this corner location is on back of page.

I hereby certify that this document and the data contained herein was prepared by me or under my direct supervision.

Stacy C. Mooney 6-26-95  
SIGNATURE DATE

Registration No. 11943

Land Surveyor,  Professional Engineer

County Surveyor,  County Engineer

### OFFICE OF THE COUNTY RECORDER

County of \_\_\_\_\_

I hereby certify that this document was filed in the Co. Recorders office at \_\_\_\_\_ .M. on the \_\_\_\_\_ day of \_\_\_\_\_ A.D., 19 \_\_\_\_\_

County Recorder \_\_\_\_\_

By \_\_\_\_\_, Deputy

DOCUMENT NO. \_\_\_\_\_

Statement of Evidence:

On June 17, 1995, we found a R.R. spike set by the DNR. We tied it out and dug with back hoe. Elvin Larson stopped by and told us that the DNR had dug several times with a back hoe and found nothing. We stopped digging and set a 5/8" iron stake w/seal #11943 inplace of R.R. spike.